

Name:		
Location:		
Email:		
Phone:	Cell:	
Fax:	Cover: 14 oz KEDER	
Length:	Centers: 10' OR 15'	Arc: 88'
Rafter Coating: ASTM-A123 Hot Dip Galvanized 3.9 mils Zinc		
Foundation:		

<b>62' PROFILE</b>	
<b>ADVANTAGE PLUS TRUSS</b>	
Notes:	

THIS DOCUMENT CONTAINS  
INFORMATION PROPRIETARY TO  
ACCU-STEEL INC. IT SHALL NOT BE  
REPRODUCED, USED, OR DISCLOSED  
WITHOUT PRIOR WRITTEN  
PERMISSION OF ACCU-STEEL INC.

Date: 6/14/2010

Project:

Drawn By:

Sales #



**ADVANTAGE**  
STRUCTURES

Advanced  
Quality Building Solution  
From



**Accu-Steel**  
Inc.

**1-877-338-6936**  
[www.asicoverbuildings.com](http://www.asicoverbuildings.com)

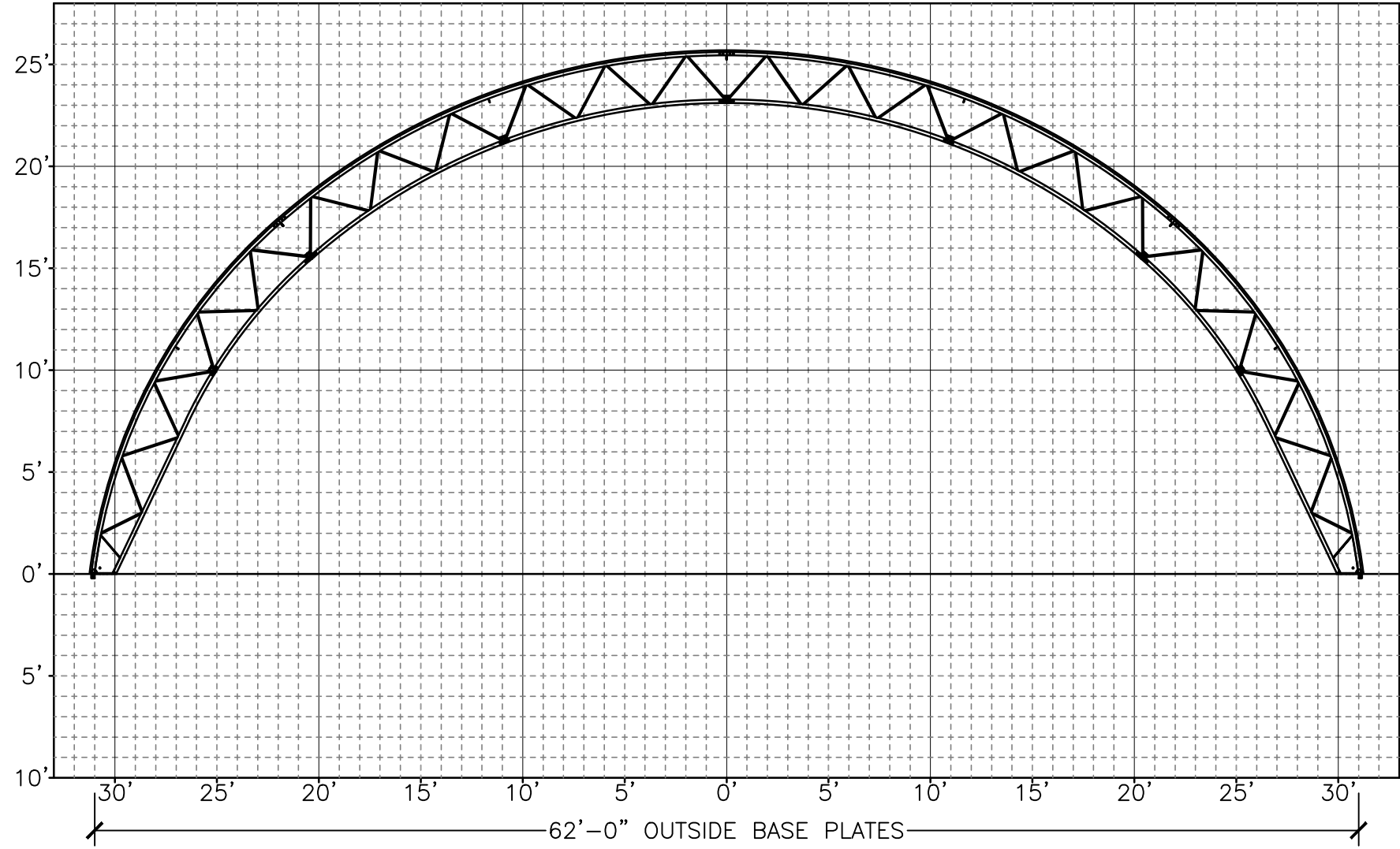

1'x1' GRID